

# OWNER'S MANUAL

## OVERHEAD LOAD LIFTER MODEL OLA

### Table of Contents:

|                                |   |                               |   |
|--------------------------------|---|-------------------------------|---|
| Safe Use Recommendations ..... | 1 | Inspections .....             | 2 |
| Receiving Instructions .....   | 1 | Label Placement Diagram ..... | 3 |
| Operation .....                | 2 | Limited Warranty.....         | 4 |

### SAFE USE RECOMMENDATIONS

Before using the pallet lifter, read and understand the entire manual to insure safe operation. Inspect the unit including warning labels before each use for damage. Only use the lifter if it is in normal operating condition.

This Overhead Pallet Lifter is to be used in conjunction with an overhead hoist with the proper capacity only. The pallet lifter weight needs to be added into the total weight of the load.

**WARNING!** Material handling is dangerous. Improper use of this lifting device might result in serious personal injuries.

- DO NOT exceed rated capacity of lifter.
- DO NOT use lifter if damaged, malfunctioning, or missing parts.
- DO NOT lift people or lift loads over people.
- DO NOT elevate load higher than necessary.
- DO NOT leave a suspended load unattended.
- Stay clear of suspended loads.
- DO NOT use lifter until you read and understand this entire manual.
- DO NOT modify this lifter. Unauthorized modifications might make it unsafe to use and automatically void the limited warranty (see p. 4).
- DO NOT remove or obscure any label.
- Secure load to pallet **BEFORE** using this lifter.

### RECEIVING INSTRUCTIONS

Every unit is thoroughly inspected prior to shipment. However, it is possible that the unit may incur damage during transit. If damage is noticed when unloading, make a note of it on the **BILL OF LADING**. Remove all packing and strapping material, then inspect the unit again for damage. **IF DAMAGE IS EVIDENT, FILE A CLAIM WITH THE CARRIER IMMEDIATELY!**

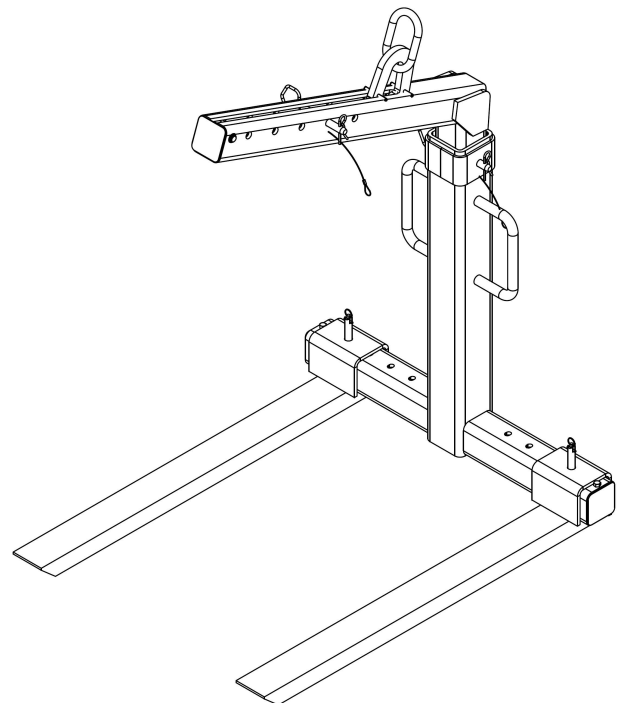

**OVERHEAD LOAD LIFTER  
MODEL OLA**

## OPERATION

This lifter is designed to be used in conjunction with closed bottom skids. Loads used with this lifter need to be secure on the skid and symmetrically distributed on the skid. Loose items falling off the pallet mid-air can cause the center of gravity to shift and cause the entire load to dump.

Insert the forks of the pallet lifter through the fork slots in the pallet until the forks are fully inserted. If the beam height needs to be adjusted, remove the height adjustment pin and either set the height with a hoist hooked into the bail or by hand. After setting the height, replace the pin and install the safety pin. Models with the adjustable fork width option can set the fork width by loosening the retainer bolts on the top of each fork and sliding the forks to the desired width. The forks must be set the same distance from the center in order to insure proper balance. After the forks have been set retighten the retaining bolts securely.

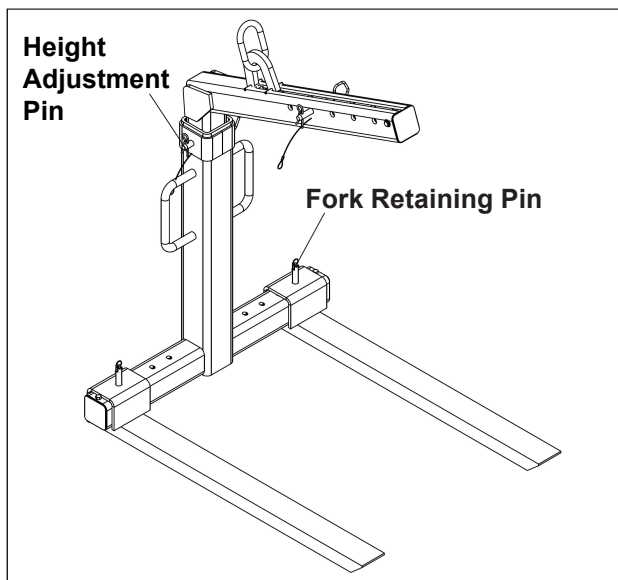
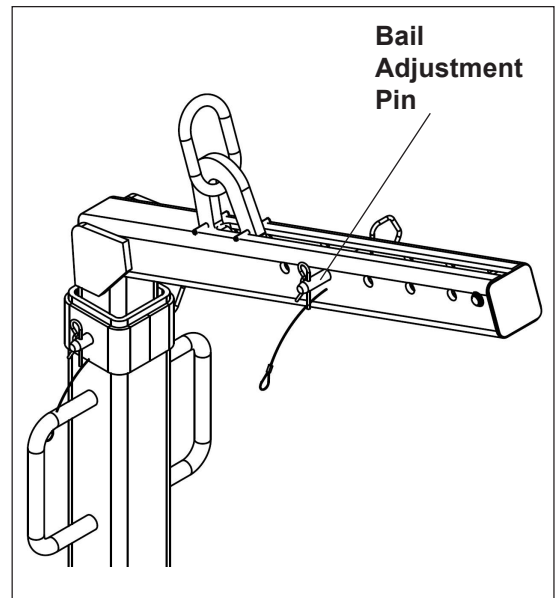

Using the overhead hoist, pick up the pallet lifter and load slowly to check for load balancing and stability. If the load is not balanced position the pallet on the forks and retry. Never extend the pallet past the edge of the forks. Never extend the pallet past the edge of the forks. If the pallet center balance is off enough, the bail stop pin may need to be repositioned.

When trying to position the pallet lifter with the load, use the handles located on the rear of the unit. Never place your feet underneath the unit when positioning the load. To remove the pallet from the lifter, place the load on the ground and with the lifter slightly raised remove the pallet lifter from the rear of the pallet. When the weight of the pallet has been removed from the forks, the pallet lifter bail will slide back and allow the lifter to balance when unloaded.

## INSPECTIONS

Set the bail adjustment pin so that the bail will stop at approximately the center of the load. Be sure all pins are in place and the safety pins are inserted into the pins. Connect the hoist hook through the bail pickup loop on the pallet lifter. Be sure that the hoist has a safety latch to insure the hook cannot slide off the bail. When moving the pallet lifter empty, the bail will return to the lower position. To be sure the bail does not slide forward, place the bail adjustment pin into the first hole position (first hole on the lower end).

As with all equipment, frequent inspections should be performed on this unit to insure safe operation. The intervals of inspection should be determined by the frequency of use. Inspect for cracked welds, worn or damaged components or torn or damaged warning labels. This lifter is built in accordance with ASME B30.20. A copy of this standard can be attained from ASME. Guidelines for testing and inspections are given in this standard.

**FIG. 1: Exploded parts diagram and parts list**

| Item no. | Part no.   | Description   | Quantity |
|----------|------------|---|----------|
| 1        | 38-514-003 | Frame hoist tube assembly   | 1        |
| 2        | 38-516-003 | Bracket, spring balance subassembly   | 1        |
| 3        | 38-528-001 | Fork subassembly  | 2        |
| 4        | 38-514-004 | Weldment, frame base subassembly  | 1        |
| 5        | 38-112-003 | <sup>13</sup> / <sub>16</sub> in. bale adjustment pin                           | 1        |
| 6        | 38-110-001 | Roller bearing retainer ring  | 2        |
| 7        | 38-112-002 | Hoist pin   | 1        |
| 8        | 13154      | <sup>7</sup> / <sub>16</sub> in. – 14UNC x <sup>7</sup> / <sub>8</sub> in. bolt | 2        |
| 9        | 36108      | <sup>7</sup> / <sub>16</sub> in. – 14 zinc-plated hex nut                       | 2        |
| 10       | 38-117-001 | Retainer ring for <sup>3</sup> / <sub>4</sub> in. shaft                         | 2        |
| 11       | 38-112-016 | <sup>3</sup> / <sub>4</sub> in. height adjustment pin                           | 1        |
| 12       | 45282      | #6 hitch pin clip   | 2        |

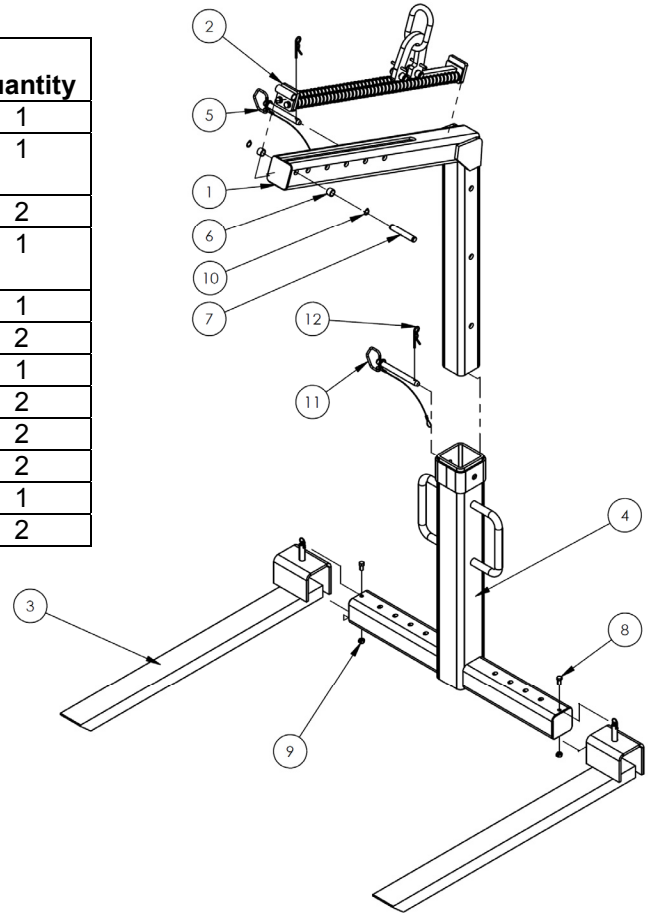

**Label placement diagram:**

The pallet lifter should be labeled at all times as shown in the diagram below. Replace any label that is missing, damaged or unreadable.

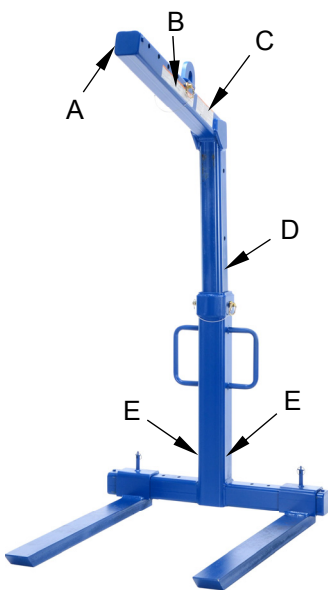

**A: Label 203**



**B: Label 675 (Hazards associated with use)**

| ⚠ WARNING   | ⚠ ADVERTENCIA  |
|---|--|
| <ul style="list-style-type: none"> <li>DO NOT exceed rated capacity</li> <li>DO NOT use if damaged, malfunctioning, or missing parts</li> <li>DO NOT lift people OR lift loads over people</li> <li>DO NOT raise load higher than necessary</li> <li>DO NOT leave a suspended load unattended</li> <li>DO NOT use lifter unless you read and understand the owner's manual</li> <li>DO NOT alter OR modify lifter</li> <li>DO NOT remove OR obscure any label</li> <li>STAY CLEAR of suspended loads</li> <li>Secure load before using this device</li> </ul> | <ul style="list-style-type: none"> <li>NO exceda la capacidad tasada</li> <li>NO USE is las partes estan dañadas, no funcionan correctamente o faltan partes.</li> <li>NO eieve al personal o eieve cargas sobre el personal</li> <li>NO eieve la carga mas alto de lo necesario</li> <li>NO deje desatendida una carga que este suspendida</li> <li>NO use el elevador a no ser que haya leído y entendido las instrucciones del manual del propietario</li> <li>NO altere o modifique el elevador</li> <li>NO quite u oscurezca ninguna etiqueta</li> <li>MANTENGASE alejado de las cargas suspendidas</li> <li>Asegure la carga antes de usar este dispositivo</li> </ul> |

**C: Label 531 (Hazards associated with use)**

| ⚠ WARNING   | ⚠ ADVERTENCIA   |
|---|---|
| PLACE BAIL STOP PIN IN HOLE THAT WILL STOP BAIL OVER CENTER OF LOAD<br>Failure to do this may result in load dumping<br>PLACE BAIL STOP PIN IN FIRST HOLE WHEN MOVING EMPTY LIFTER<br>FULLY INSERT PINS BEFORE LIFTING<br>KFFP (I) FAR OF PINCH POINT ON TOP<br>STAND CLEAR WHILE LIFTING<br>CONSULT OWNERS MANUAL BEFORE USE | PONGA EL PASADOR DE PARADA BAIL EN EL AGUJERO QUE PARARÁ EL BAIL SOBRE EL CENTRO DE LA CARGA<br>Si no se hace podría resultar en que la descarga de la carga<br>PONGA EL PASADOR DE PARADA BAIL EN EL PRIMER AGUJERO CUANDO SE MUEVA EL ELEVADOR VACÍO<br>INSERTE LOS PASADORES COMPLETAMENTE ANTES DE ELEVAR<br>MANTENGASE AL FUJADO DEL PUNTO DE CORTE EN LA CIMA<br>APARTESE CUANDO SE ELEVE<br>CONSULTE CON EL MANUAL DEL PROPIETARIO ANTES DE USAR |

**D: Label 320:**

|  |            |
|--|------------|
| MODEL NUMBER/NÚMERO MODELO                       | _____      |
| RATED LOAD                                       | _____ LBS. |
| CARGA TASADA                                     | _____ KGS. |
| WEIGHT OF LIFTER                                 | _____ LBS. |
| PESO DE LA UNIDAD                                | _____ KGS. |
| SERIAL NUMBER/NÚMERO DE SERIE:                   | _____      |
| BTH-1 Design Category/Diseño BTH-1 Categoría:    | <b>B</b>   |
| BTH-1 Service Category/Servicio BTH-1 Categoría: | <b>1</b>   |

**E: Label 991**



## LIMITED WARRANTY

Vestil Manufacturing Corporation ("Vestil") warrants this product to be free of defects in material and workmanship during the warranty period. Our warranty obligation is to provide a replacement for a defective original part if the part is covered by the warranty, after we receive a proper request from the warrantee (you) for warranty service.

### Who may request service?

Only a warrantee may request service. *You are a warrantee if* you purchased the product from Vestil or from an authorized distributor AND Vestil has been fully paid.

### What is an "original part"?

An original part is a part used to make the product as shipped to the warrantee.

### What is a "proper request"?

A request for warranty service is proper if Vestil receives: 1) a photocopy of the Customer Invoice that displays the shipping date; AND 2) a written request for warranty service including your name and phone number. Send requests by any of the following methods:

|   |  |                  |
|---|--|------------------|
| <u>Mail</u>   | <u>Fax</u>                                       | <u>Email</u>     |
| Vestil Manufacturing Corporation<br>2999 North Wayne Street, PO Box 507<br>Angola, IN 46703 | (260) 665-1339<br><u>Phone</u><br>(260) 665-7586 | sales@vestil.com |

In the written request, list the parts believed to be defective and include the address where replacements should be delivered.

### What is covered under the warranty?

After Vestil receives your request for warranty service, an authorized representative will contact you to determine whether your claim is covered by the warranty. Before providing warranty service, Vestil may require you to send the entire product, or just the defective part or parts, to its facility in Angola, IN. The warranty covers defects in the following *original* dynamic components: motors, hydraulic pumps, electronic controllers, switches and cylinders. It also covers defects in *original* parts that wear under normal usage conditions ("wearing parts"), such as bearings, hoses, wheels, seals, brushes, and batteries.

### How long is the warranty period?

The warranty period for original dynamic components is 1 year. For wearing parts, the warranty period is 90 days. The warranty periods begin on the date when Vestil ships the product to the warrantee. If the product was purchased from an authorized distributor, the periods begin when the distributor ships the product. Vestil may, at its sole discretion, extend the warranty periods for products shipped from authorized distributors by *up to* 30 days to account for shipping time.

### If a defective part is covered by the warranty, what will Vestil do to correct the problem?

Vestil will provide an appropriate replacement for any *covered* part. An authorized representative of Vestil will contact you to discuss your claim.

### What is not covered by the warranty?

1. Labor;
2. Freight;
3. Occurrence of any of the following, which automatically voids the warranty:
  - Product misuse;
  - Negligent operation or repair;
  - Corrosion or use in corrosive environments;
  - Inadequate or improper maintenance;
  - Damage sustained during shipping;
  - Collisions or other incidental contacts causing damage to the product;
  - Unauthorized modifications: DO NOT modify the product IN ANY WAY without first receiving written authorization from Vestil. Modification(s) might make the product unsafe to use or might cause excessive and/or abnormal wear.

### Do any other warranties apply to the product?

Vestil Manufacturing Corp. makes no other express warranties. All implied warranties are disclaimed to the extent allowed by law. Any implied warranty not disclaimed is limited in scope to the terms of this Limited Warranty.

